

State of Louisiana

Parish of Lafourche

Act of Dedication

Before the undersigned Notary Public in and for the aforesaid State and Parish, personally came and appeared:

RR and DD, LLC, a Louisiana limited liability company, whose permanent mailing address is 192 Acadia Woods Drive, Thibodaux, Louisiana, 70301, represented herein by its duly authorized representative ("**RR and DD**");

who does hereby declare and state that by this Act, it does hereby grant, donate and dedicate to the **City of Thibodaux**, a municipality located in Lafourche Parish, Louisiana, and its **Utility Department**, represented herein by its undersigned Mayor, who accepts the said dedication on behalf of the City, said property being more fully described as follows, to-wit:

A certain lot or tract of land being situated within the Benjamin Estates Subdivision property owned by RR and DD, LLC being 159.98 feet in a northeasterly direction from the southwesterly intersection of Oakley and Calumet Street right of ways, located in Section 78, Township 15 South - Range 16 East, Terrebonne Parish, labeled as "Permanent 20.00' x 30.00' Lift Station Servitude" (the "**Lift Station**") on **Exhibit A**, attached hereto and incorporated herein, the legal description of which is also shown on **Exhibit A**, for the use, operation, repair, replacement and maintenance of sewer improvements including an 8" sewer line and a sewer lift station, including but not limited to, a 4" sewer force main and two (2) permanent pumps (collectively defined herein as the "**Lift Station Improvements**").

An exclusive ten (10') foot wide underground servitude situated ten (10') feet southeasterly and adjacent to the property line between Lot 6 and Lot 7, Block 1, of Benjamin Estates Subdivision extending from the Benjamin Drive right of way to the Permanent 25'x25' Lift Station Servitude located in Section 78, Township 15 South - Range 16 East, Terrebonne Parish, Louisiana belonging to RR and DD, LLC labeled as "10' Sewer Servitude" (the "**Sewer Force Main**") on **Exhibit B**, attached hereto and incorporated herein, the legal description of which is also shown on **Exhibit B**, for the use, operation, repair, replacement and maintenance of sewer improvement including but not limited to a 4" sewer force main (collectively defined herein as "**Sewer Improvements**").

All sewer improvements including 8" sewer lines, sewer manholes, sewer services, and 4" sewer force main located within the Terrebonne Parish Consolidated Government public road right-of-way and adjacent utility servitudes.

In consideration of an impact fee in the amount of **Ten Dollars (\$10.00)**, and other good and valuable consideration, the receipt of is hereby acknowledged, the City of Thibodaux and the Utility Department hereby accepts the dedication of the Lift Station and Sewer Force Main Improvements and agrees that the City of Thibodaux will be responsible for maintenance and repairs to the Improvements. RR and DD will not have any further obligation or responsibility to repair or maintain the Improvements.

Signed this ____ day of _____, 2023, in Thibodaux, Louisiana, before the undersigned Notary Public and witnesses.

Witnesses:

RR and DD, LLC

Name: _____

Name: _____

By: _____

Name: David L. Duplantis

Its: Managing Member

Notary Public

Print Name: _____

Bar Roll/Notary No.: _____

My Commission Expires: _____

Signed this ____ day of _____, 2023, in Thibodaux, Louisiana, before the undersigned Notary Public and witnesses.

Witnesses:

City of Thibodaux

Name: _____

Name: _____

By: _____

Name: _____

Its: Mayor

Notary Public

Print Name: _____

Bar Roll/Notary No.: _____

My Commission Expires: _____

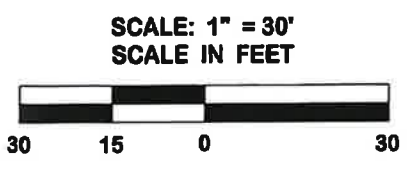
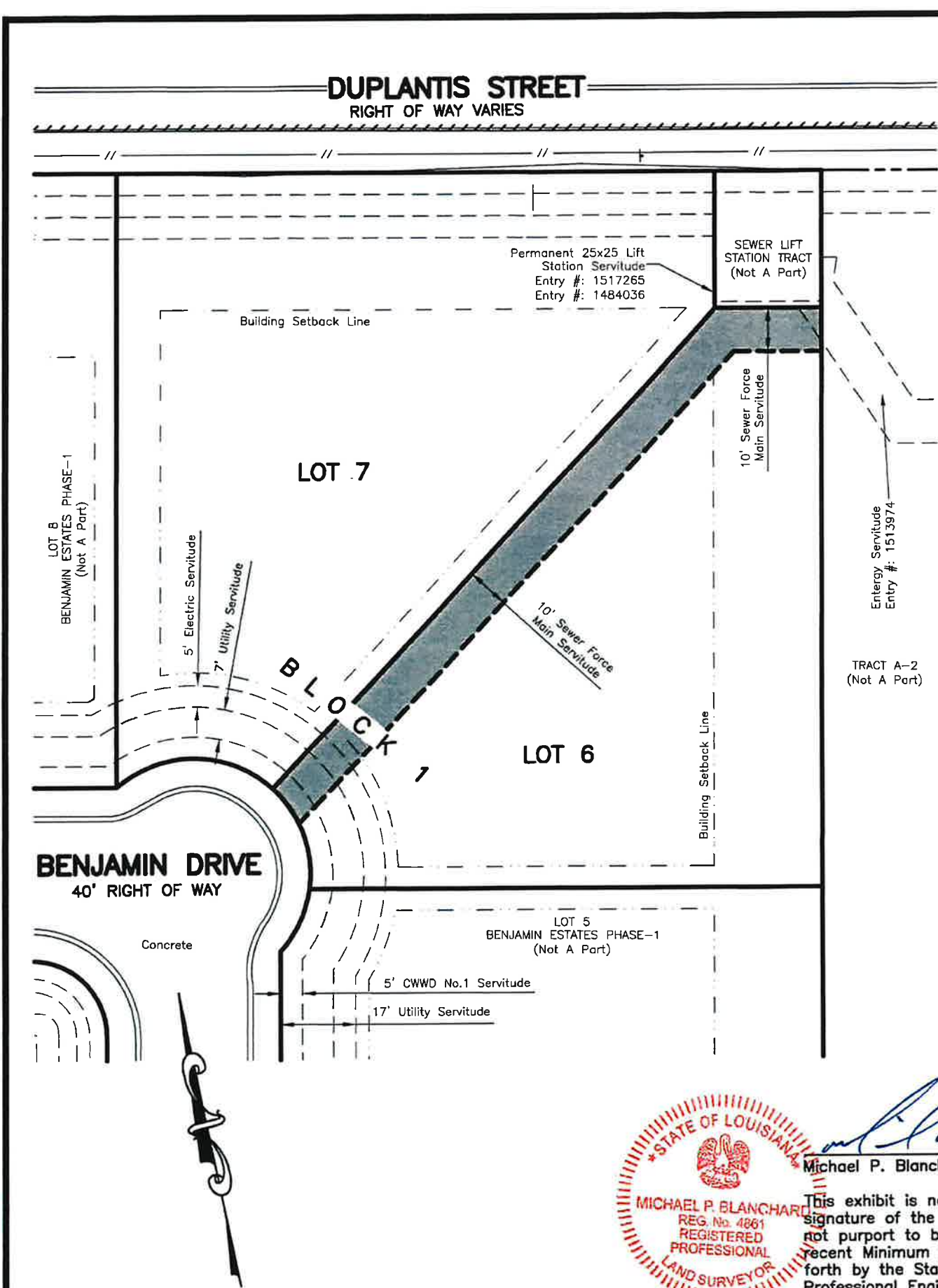

- NOTES:**
- 1.) No attempt has been made by Acadia Land Surveying, L.L.C. to verify title, actual legal ownership, deed restrictions servitudes, easements, alleys, right-of-ways or other burdens on the property, other than that furnished by the client or his representative. There is no representation that all applicable servitudes and restrictions are shown hereon. The surveyor has made no title search or public record search in compiling the data for this survey.
 - 2.) The words "Certify," "Certifies" or "Certification" as used hereon is understood to be an expression of professional opinion by the surveyor, based upon his best knowledge, information, and belief, as such, it does not constitute a guarantee nor a warranty, expressed or implied.

REFERENCE MAP & BEARINGS:
 Plat Showing Resubdivision of Property Belonging to Benjamin Roth, JR. Family, LLC into Tracts A-1 (Raw Land), A-2, A-3, & A-4 Benjamin Roth, Jr. Family, LLC. Subdivision Located in Section 78, T15S-R16E, Terrebonne Parish, Louisiana
 Prepared by: Acadia Land Surveying, LLC Dated: May 19, 2015 Entry No. 148403

FEMA FLOOD ZONE AND HAZARDS:
 Flood Note: The property hereon is located in Flood Zone "C" (Areas of minimal flooding. No shading.) in accordance with FEMA Flood Insurance Rate Map Panel Number 2252060395C, dated May 1, 1985, for Terrebonne Parish, Louisiana. The property is located outside the limits of the ABFE zone in accordance with Panel LA-W99 dated February 23, 2006 of the Hurricane Rita Advisory Base Flood Elevation (ABFE) Maps for Terrebonne Parish. Base Flood Elevation is subject to change and should be verified with the local authority's Flood Plain Administrator before any design or construction

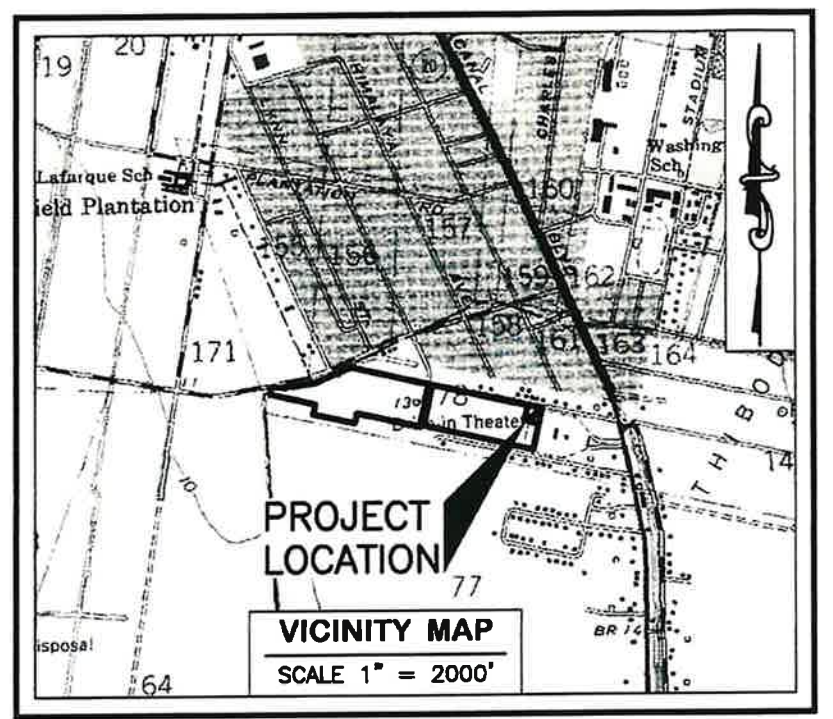

**10' SEWER
 FORCE MAIN SERVITUDE
 FOR
 BENJAMIN ESTATES (PHASE 1)
 LOCATED IN SECTION 78,
 TOWNSHIP 15 SOUTH – RANGE 16 EAST
 TERREBONNE PARISH, LOUISIANA
 BELONGING TO
 RR AND DD, LLC**





 Michael P. Blanchard, P.L.S., Reg. No. 4861

This exhibit is not valid without the raised or colored seal and signature of the Registered Land Surveyor. This exhibit also does not purport to be a boundary survey and does not meet the most recent Minimum Standards of Practice for Land Surveyors as set forth by the State of Louisiana, Board of Registration for Professional Engineers and Land Surveyors.



ACADIA

LAND SURVEYING, LLC

 ALABAMA • LOUISIANA • MISSISSIPPI • TEXAS

206 EAST 2ND STREET, THIBODAUX, LOUISIANA 70301
 Phone • (985) 449-0094 Fax • (985) 449-0085
 EMAIL • ACADIA@ACADIALANDSURVEYING.COM

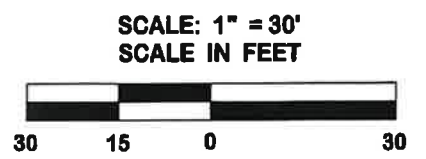
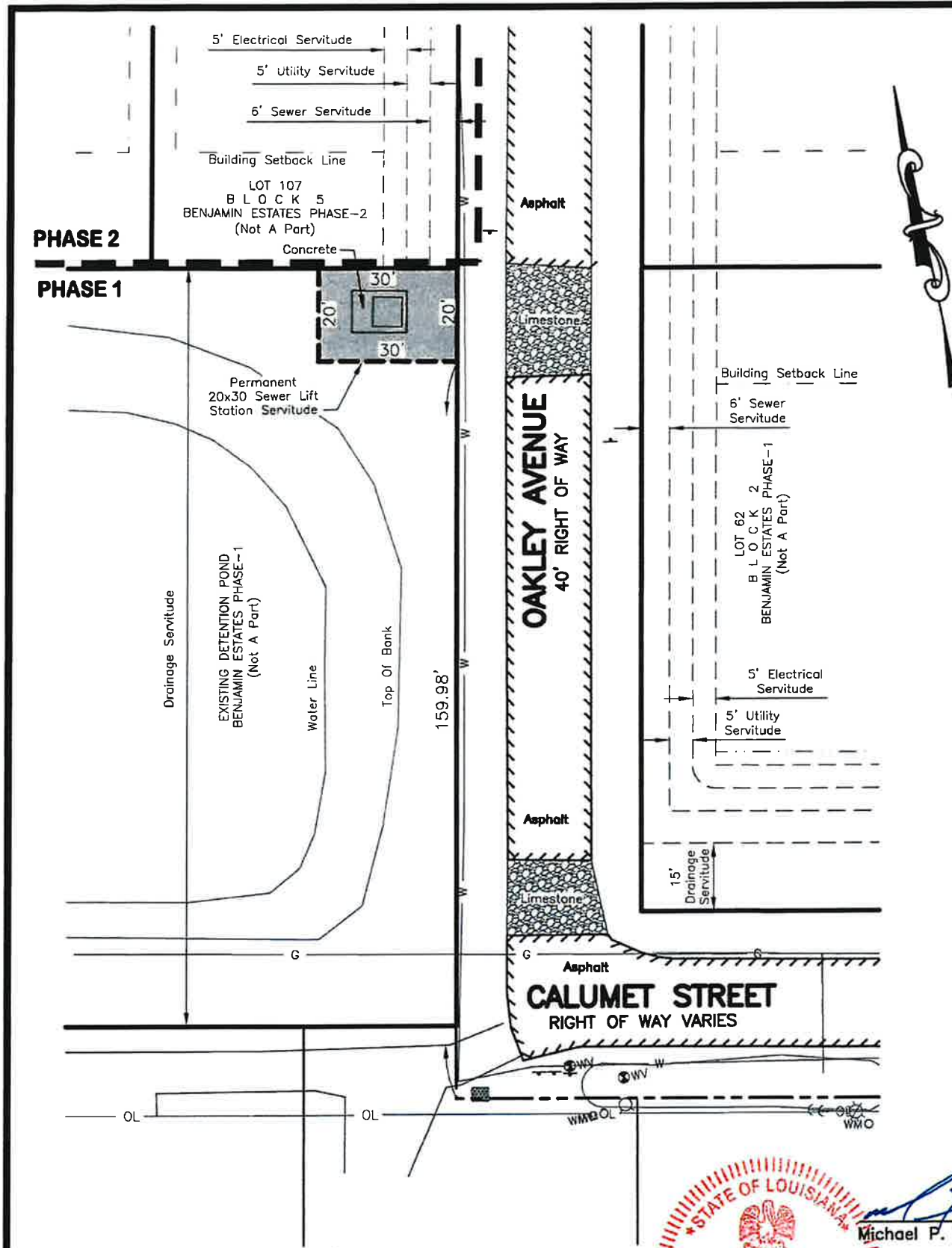



- NOTES:**
- 1.) No attempt has been made by Acadia Land Surveying, L.L.C. to verify title, actual legal ownership, deed restrictions servitudes, easements, alleys, right-of-ways or other burdens on the property, other than that furnished by the client or his representative. There is no representation that all applicable servitudes and restrictions are shown hereon. The surveyor has made no title search or public record search in compiling the data for this survey.
 - 2.) The words "Certify," "Certifies" or "Certification" as used hereon is understood to be an expression of professional opinion by the surveyor, based upon his best knowledge, information, and belief, as such, it does not constitute a guarantee nor a warranty, expressed or implied.

REFERENCE MAP & BEARINGS:
 Plat Showing Resubdivision of Property Belonging to Benjamin Roth, JR. Family, LLC into Tracts A-1 (Raw Land), A-2, A-3, & A-4 Benjamin Roth, Jr. Family, LLC. Subdivision Located in Section 78, T15S-R16E, Terrebonne Parish, Louisiana
 Prepared by: Acadia Land Surveying, LLC Dated: May 19, 2015 Entry No. 148403

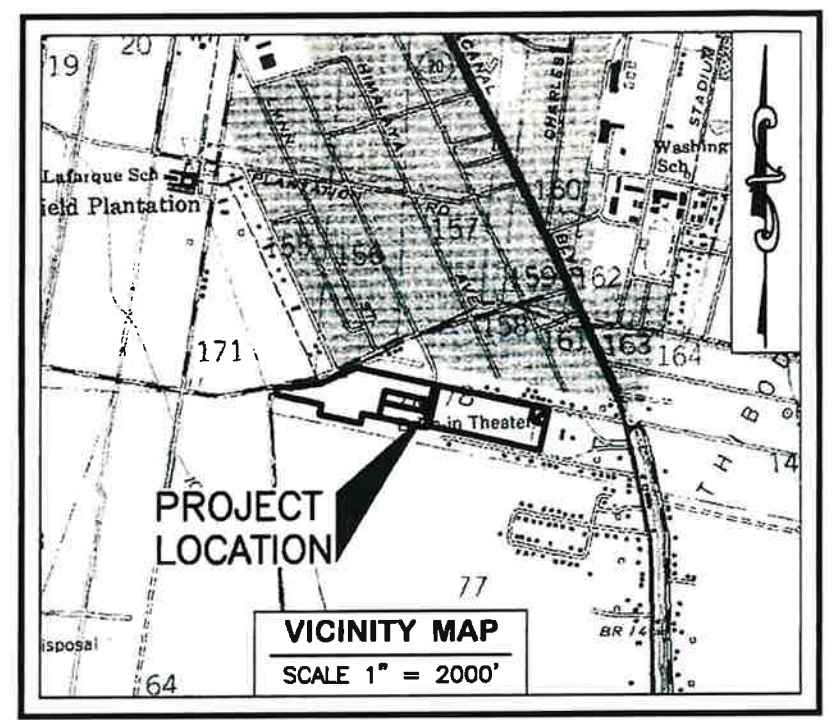
FEMA FLOOD ZONE AND HAZARDS:
 Flood Note: The property hereon is located in Flood Zone "C" (Areas of minimal flooding. No shading.) in accordance with FEMA Flood Insurance Rate Map Panel Number 2252060395C, dated May 1, 1985, for Terrebonne Parish, Louisiana. The property is located outside the limits of the ABFE zone in accordance with Panel LA-W99 dated February 23, 2006 of the Hurricane Rita Advisory Base Flood Elevation (ABFE) Maps for Terrebonne Parish. Base Flood Elevation is subject to change and should be verified with the local authority's Flood Plain Administrator before any design or construction



**PERMANENT 20'X30' SEWER
 LIFT STATION SERVITUDE
 FOR
 BENJAMIN ESTATES (PHASE 1)
 LOCATED IN SECTION 78,
 TOWNSHIP 15 SOUTH - RANGE 16 EAST
 TERREBONNE PARISH, LOUISIANA
 BELONGING TO
 RR AND DD, LLC**

 Michael P. Blanchard, P.L.S., 02/10/2023
 Reg. No. 4861

This exhibit is not valid without the raised or colored seal and signature of the Registered Land Surveyor. This exhibit also does not purport to be a boundary survey and does not meet the most recent Minimum Standards of Practice for Land Surveyors as set forth by the State of Louisiana, Board of Registration for Professional Engineers and Land Surveyors.

ACADIA
LAND SURVEYING, LLC
 ALABAMA • LOUISIANA • MISSISSIPPI • TEXAS
 206 EAST 2ND STREET, THIBODAUX, LOUISIANA 70301
 Phone • (985) 449-0094 Fax • (985) 449-0085
 EMAIL • ACADIA@ACADIALANDSURVEYING.COM