



**PLANNING & ZONING COMMISSION
APPLICATION FOR ZONING AMENDMENT
P.O. Box 5418
Thibodaux, Louisiana 70302**

Application No. 1

The undersigned, owner(s) of the following legally described property, hereby request the consideration of change in zoning district classification as specified below:

1. Name of Applicant: Shonell Tolbert

2. Mailing Address: 613 maple st Thibodaux La 70301
 Phone Number(s): Home: 985 227-9262 Work: _____ Cell: 985 665 9600

3. Locational Description: Subdivision Name: _____
 Block No.: _____ Lot No.: _____ (If not in a platted subdivision, attach a legal description.)

Building Address: 1001 plantation rd A+B

4. Existing Use: _____

5. Present Zoning District: R-3

6. Proposed Use: Salon

7. Proposed Zoning District: C1

Supporting Information - attach the following items to the application:

- a. Vicinity map showing property lines, streets and existing and proposed zoning.
- b. A list of all property owners and their mailing addresses within, contiguous to and directly across the street from the proposed re-zoning.
- c. A statement of general compatibility of re-zoning with adjacent and other property in the district.
- d. Site map with measurements of property to be re-zoned (legal description if available).

Date: 1/23/18

Shonell Tolbert
Applicant's Signature

**(For Official Use Only)
City of Thibodaux, Louisiana Planning and Zoning Commission**

Date Filed: _____

Date of Notice in Newspaper: _____

Date of Notice to Adjacent Property Owner: _____

SKETCH ADDENDUM

Borrower or Owner **Shonell & Renata Tolbert**
 Property Address **1001 Plantation Drive**
 City **Thibodaux** County **Lafourche** State **LA** Zip Code **70301-4239**
 Client **South Lafourche Bank**

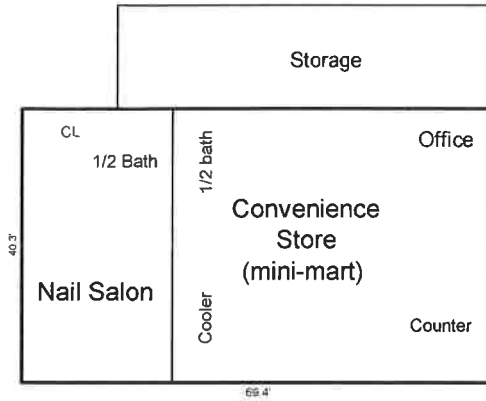

Concrete Parking

Sketch by Apex IV Windows™

AREA CALCULATIONS SUMMARY			
Code	Description	Size	Totals
GLA1	First Floor	2796.82	2796.82
TOTAL LIVABLE (rounded)			2797

LIVING AREA BREAKDOWN			
Breakdown			Subtotals
First Floor			
40.3	x	69.4	2796.82
1 Area Total (rounded)			2797

0010243244

Assessment Number: 0010243244

Owner Name: NGUYEN FAMILY, INC., T.I.D.

Owner Address: ATTEN: HA THU THI NGUYEN 1001 PLANTATION ROAD

Owner City: THIBODAUX LA 70301-

Parcel Address: 1001

Parcel Street Name: PLANTATION RD.

PLSS:

Acreage: 0.14506787860629

Ward: W 01 THIB

Subdivision: WILLIAMS SD, ADD. 3

Lot:

Block:

Legal: 1ST: LOT 22, BLOCK 4, ADD. 3, WILLIAMS SD; (82' -1/4" FRONT X 78'9-3/4"N; 81'3-5/8"S; 68'1-1/2"REAR). (1038-89) (1034-58) (752-705) (705-416) 2ND: LOT 22A, B

Geoportail map



January 31, 2018

DISCLAIMER: Every reasonable effort has been made to assure the accuracy of the data presented. The Lafourche Parish Assessor's Office makes no warranties, express or implied, regarding the completeness, reliability or suitability of the site data and assumes no liability associated with the use or misuse of said data. The Assessor retains the right to make changes and update data on this site at anytime without notification. The parcel data on the base map is used to locate, identify and inventory parcels of land in the Parish of Lafourche only, and is not to be used or interpreted as a legal survey or legal document. Additional data layers not originating in the Assessor's Offices are also presented for informational purposes only. Before proceeding in any legal matter, all data should be verified by contacting the appropriate parish or municipal office.

1 inch = 63 feet



